



# Single-shaft paddle mixers



TYPE PM 8.000

## General

The stringent requirements that are set for mixers in the grain-processing industry were the starting point for the development of Ottevanger's highly accurate mixers. One of the most important concepts is the single-shaft paddle mixer.

Ottevanger mixers are designed for mixing dry powders and granulates, regardless of their density or shape. And liquids can be added during the mixing process.

## Operation

Ottevanger single-shaft paddle mixers are equipped with pneumatically operated bottom flaps under the entire mixing trough. This reduces the discharge time to approx. 15-20 sec. The mixer can operate fully automatically with a capacity of max. 15 batches per hour.

## Features

- » mixing accuracy of 1:100,000/variation coefficient <4%\*
- » dry mixing time between 90 and 120 seconds
- » unloading time of approx. 15-20 seconds
- » reliable design
- » low maintenance
- » low energy consumption
- » hygienic design
- » easy to adjust and replace paddles
- » types PM 4.000 - PM 12.000 are divisible (incl. head shield)
- » all motors are suitable for frequency control
- » bolt-on head shields/end shields

\*Indicative, depending on the formulation

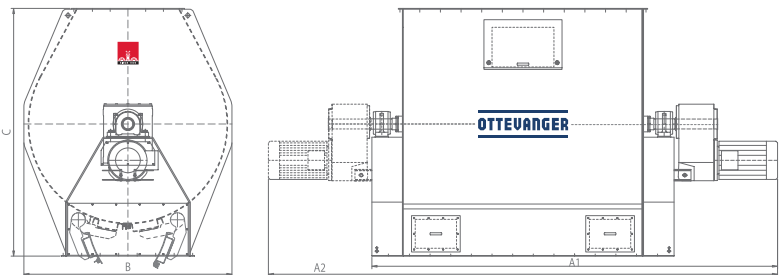

Type	Contents (ltr.)	Drive (kW)	Dimensions (mm)				Weight (kg) *
			A1	A2	B	C	
PM 100	100	2,2	1.525	-	658	650	400
PM 300	300	5,5	2.085	-	862	1.050	900
PM 500	500	9,2	2.405	-	1.000	1.300	1.300
PM 1.000	1.000	11	2.725	-	1.210	1.600	1.950
PM 2.000	2.000	18,5	3.415	-	1.460	1.900	2.600
PM 4.000	4.000	30	4.005	-	1.810	2.200	4.800
PM 6.000	6.000	45	4.605	-	2.115	2.550	6.500
PM 8.000	8.000	2x37	-	5.600	2.320	2.725	9.800
PM 10.000	10.000	2x45	-	6.545	2.520	3.000	11.500
PM 12.000	12.000	2x55	-	7.065	2.750	3.200	13.500

\*) Weight incl. motor

## Special execution

- » stainless steel models
- » types PM 500 - PM 10.000 optionally with increased output
- » rilsan coating on the mixing shaft
- » ATEX22-certified parts
- » all models also available as non-divisible



# OTTEVANGER

MILLING ENGINEERS

- » Design » Engineering » Manufacturing » Construction and commissioning
- » Feed mills » Pet food plants » Aqua feed plants » Cereal processing plants
  - » Soybean processing plants » Premix and concentrate plants » Silos
  - » Bulk storage and handling systems » Electric control and automation



## Ottevanger Milling Engineers B.V.

Location: Moerkapelle  
Moerkapelse Zijde 32  
2751 DL MOERKAPELLE  
The Netherlands  
Tel. +31 (0)79 593 22 21

Location: Aalten  
Dinxperlosestraatweg 62  
7122 AH AALTEN  
The Netherlands  
Tel. +31 (0)543 472 688

Location: Heteren  
Komkleiland 4  
6666 MG HETEREN  
The Netherlands  
Tel. +31 (0)26 47 906 99

[www.ottevanger.com](http://www.ottevanger.com)  
[info@ottevanger.com](mailto:info@ottevanger.com)